

Xspot Groove and Xcover plate instructions

Installing the Xcover plate with Groove (Rough-in phase)

During installation of conduit, replace any box Cover with an Xspot cover plate for one of three types of boxes, 4Square/Double Gang, Single Gang or Octagonal. Place the Groove centered on the back with the flat sides facing the the flanges on the back of the cover plate, turn 90 degrees to lock in place. The groove sides will lock into the ridges on the flanges, holding it securely. Attach the wire to the Groove using the hoop ring on the top and attach as you would any box cover.



Groove

Holes for either a 4Square or double gang box

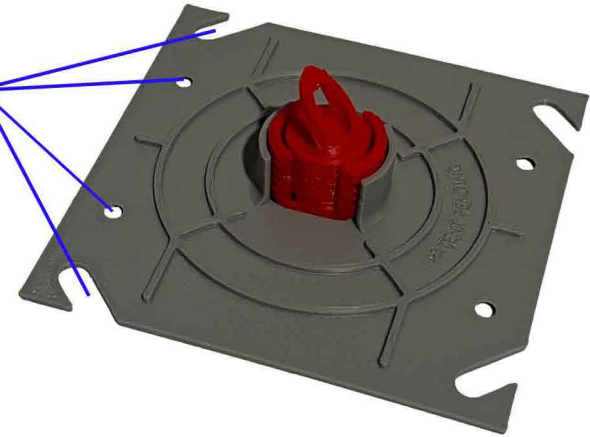

Plastering over the cover plate (Trim phase)

After the concrete forms have been removed, the Xspot cover plates can be skim coated with plaster or cement to give a clean and uncluttered look while still keeping future locations easily accessible.



Xcover - single



Xcover - octagonal



Xcover - 4square/double

Locate buried Groove and wire (Trim phase)

Locate the Groove using the Xtreme locator deep sensing tools. Start with the Xtreme facing the blue side down until you feel it "push back" when passing over buried Groove. Flip over to confirm that it attracts; ignore anything that attracts to both sides. Once location is found, scan with red side of the Xcentric centering tool allowing it snap to the center on the Groove. Make 4 marks close to the center of Xcentric and draw two lines to create a drill point.



Xtreme



Xcentric

Outline of 1" hole drilled into plaster/concrete to access the cover underneath

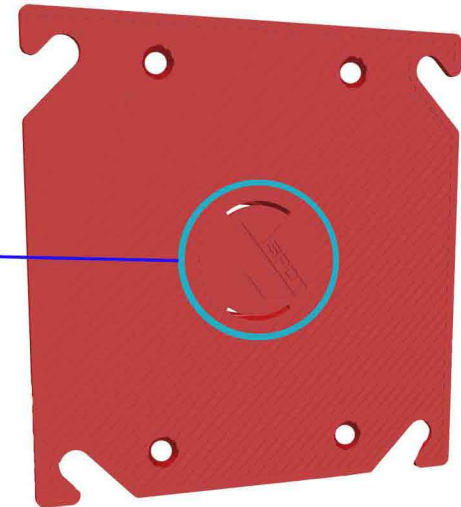

Trim wire hole with Xgrommet (Trim phase)

If you are only looking to drill a 1" hole, use a concrete hole saw bit. Lay one edge of the bit against the surface covering the Groove, an equal distance from the center point, and proceed to drill a line in the plaster/concrete skim coat. Once you have a deep enough line, tilt the bit up slowly until it is flat against the surface and drilling out the full hole. Use an Xgrommet to trim out the 1" hole.



Xgrommet



Use a 1 inch concrete drill bit to cut a perfect hole.

If you want to break out the entire box area, we recommend scoring around the outside shape of the box to make for a clean opening.

See additional applications on our website

xspotproducts.com



Xspot, how technology is found.